

PBA Pratt Burnerd MK3 3-Jaw Self-Centering Power Chucks



Chuck shown with optional hard reversible top jaws.

Power Chucks

Turn your engine lathe into a production machine with this easy retrofit self-contained power chuck.

- ⊕ One-year warranty
- ⊕ Precision manufactured to fit types A and D spindles and adapter mounting
- ⊕ Repetitive gripping within .001" TIR
- ⊕ Safe, Chuck operates independently of air supply when gripping
- ⊕ No separate actuating cylinder
- ⊕ No draw tube to restrict thru-hole
- ⊕ Sizes 6 1/2", 8", 10", 12", and 14"
- ⊕ Suitable for chucking or barwork
- ⊕ Less overhang. Lighter in weight
- ⊕ Minimum maintenance
- ⊕ Quick, simple Lever or Foot Pedal Operation
- ⊕ Easy installation ref. page 41
- ⊕ Optional top jaws ref. page 41
- ⊕ 1/16" x 90° serrated master jaws standard with T-nut

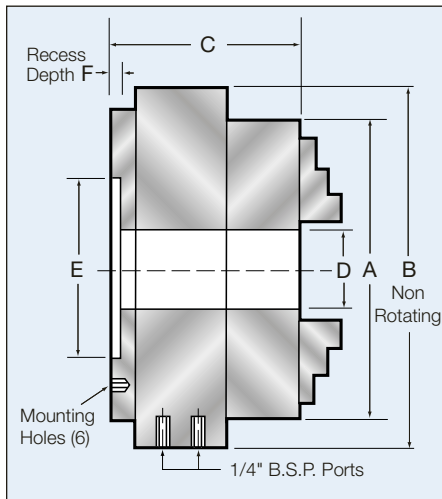

Dimensions are for adapter mount chucks.

| Chuck Size | Adapter Mount Model No. | Type D Spindles | | Type A Spindles | |
|------------|-------------------------|-----------------|-----------------|-----------------|-----------------|
| | | Spindle Size | 3-Jaw Model No. | Spindle Size | 3-Jaw Model No. |
| 6 1/2" | 3-Jaw 9760-01710 | D-3 | 9762-21710 | - | - |
| | | D-4 | 9762-31710 | - | - |
| | | D-5 | 9762-41710 | A-5 | 9761-31710 |
| | | D-6 | 9762-51710 | A-6 | - |
| 8" | 3-Jaw 9760-02110 | D-4 | 9762-32110 | - | - |
| | | D-5 | 9762-42110 | A-5 | 9761-32110 |
| | | D-6 | 9762-52110 | A-6 | 9761-42110 |
| 10" | 3-Jaw 9760-02610 | D-5 | 9762-42610 | - | - |
| | | D-6 | 9762-52610 | A-6 | 9761-42610 |
| | | D-8 | 9762-62610 | A-8 | 9761-52610 |
| 12" | 3-Jaw 9760-03210 | D-8 | 9762-63210 | A-8 | 9761-53210 |
| | | D-11 | 9762-73210 | A-11 | 9761-63210 |
| 14" | 3-Jaw 9760-03510 | D-8 | 9762-63510 | A-8 | 9761-53510 |
| | | D-11 | 9762-73510 | A-11 | 9761-63510 |

Table Mount, "L" Type Mounts and Special Mounts available upon request.

Dimensional and Technical Data (in inch)

| Chuck Size | A | B | C | D | E | F | Mtg Hole | 6-Hole B.C. | Wt. Lbs | Max rpm* | Jaw Travel | Ext. Gripping Range Std. Hard Jaws | Int. Gripping Range Std. Hard Jaws | Force** |
|------------|-------|-------|------|------|--------|-----|----------|-------------|---------|----------|------------|------------------------------------|------------------------------------|---------|
| 6 1/2 | 6.50 | 9.45 | 5.06 | 1.50 | 4.921 | .24 | M10 | 5.91 | 50 | 3000 | .180 | .63 to 7.09 | 2.80 to 7.80 | 6,930 |
| 8 | 7.87 | 10.63 | 5.16 | 2.05 | 6.102 | .24 | M10 | 7.09 | 68 | 2500 | .180 | .98 to 8.62 | 3.58 to 9.58 | 10,230 |
| 10 | 9.84 | 12.20 | 5.73 | 2.56 | 7.283 | .24 | M10 | 8.27 | 100 | 2000 | .197 | 1.22 to 10.71 | 4.45 to 11.39 | 15,180 |
| 12 1/2 | 12.40 | 13.98 | 5.79 | 3.54 | 8.858 | .26 | M10 | 9.84 | 144 | 1500 | .197 | 1.57 to 13.35 | 5.31 to 14.69 | 18,080 |
| 14 | 13.78 | 15.35 | 7.28 | 5.59 | 10.000 | .26 | M12 | 11.00 | 200 | 1300 | .236 | 3.50 to 14.60 | 7.30 to 15.90 | 18,960 |

*Max. RPM at 85 PSI with standard hard top jaws. Consult factory for increased RPM rating.

** Total Gripping Force (lbs) at 85 PSI

HOW TO ORDER: State quantity, Model Number of chuck and shipping instructions.

Pratt Burnerd Accessories and Installation For MK3 Self-Contained Power Chucks

Lever Control Unit - Part Number 1157-12800

Foot Pedal Control Unit - Part Number 1157-12801 (Not Shown)

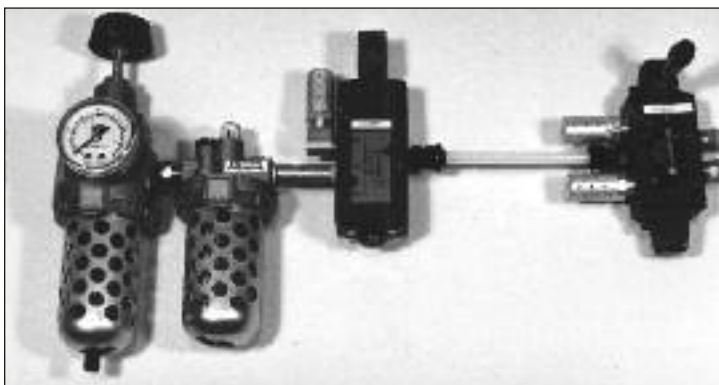

This unit is essential in order to operate MK3 self-contained power chucks. It is designed to be interlocked with the machine spindle so that the chuck cannot be actuated while the spindle is under power. Care must be taken not to actuate the chuck while the spindle is decelerating.

Units are supplied complete with pressure gage, pressure regulator, oil mist lubricator, air filter and lines with fittings.

Unit is operated by air and 110 volt/60 cycle (24 volt DC on request).

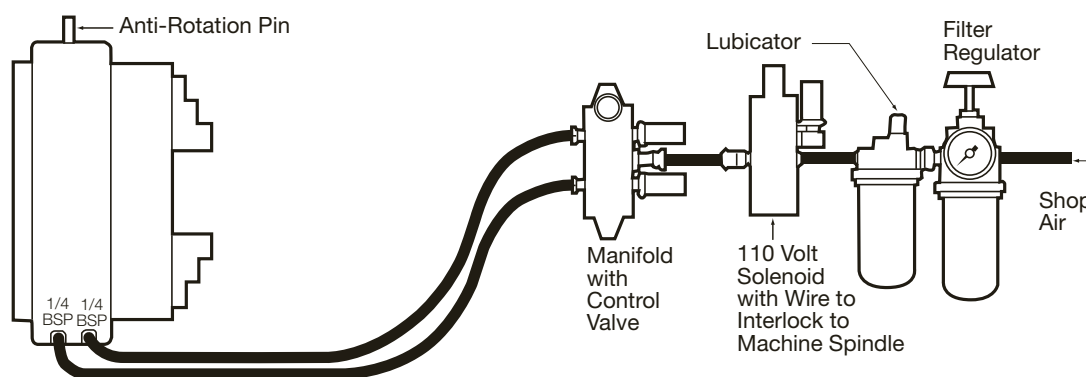

Top Jaws for MK3 Self-Contained Chucks - 1/16" x 90° Serrations

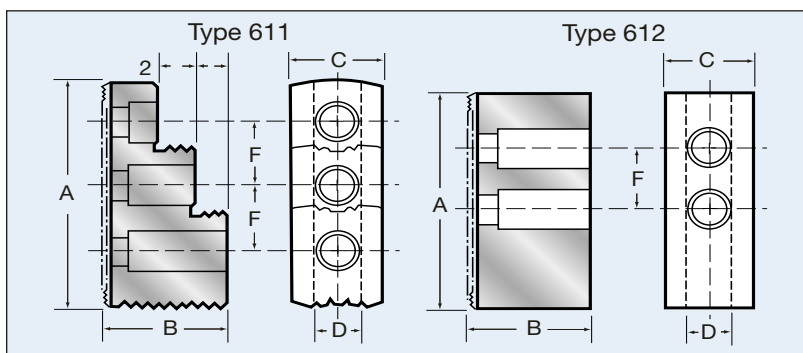

Type 611 - Hardened and ground reversible jaws with serrated gripping faces. (supplied in sets of 3 for 3 jaw chucks only)

Type 612 - Soft blank jaws, case hardening quality steel. (supplied as single units only)

Dimensional Data

| Chuck Size | Jaw Type | Part Number | A | B | C | D | F | Bolt Size | Step Height |
|------------|----------|-------------|-------|-------|-------|-------|-------|-----------|-------------|
| 6½" | 611 | 8130-17611 | 2.56" | 1.56" | 1.18" | .475" | .67" | M8 | .39" |
| 6½" | 612 | 8140-17512 | 2.75" | 1.50" | 1.25" | .475" | .787" | M8 | - |
| 8"/10" | 611 | 8130-21611 | 3.00" | 1.97" | 1.57" | .670" | .75" | M12 | .47" |
| 8"/10" | 612 | 2860-21512 | 3.50" | 2.00" | 1.50" | .670" | 1.00" | M12 | - |
| 12"/14" | 611 | 8130-31611 | 4.92" | 2.36" | 2.36" | .830" | .98" | M16 | .55" |
| 12"/14" | 612 | 2860-32512 | 4.50" | 2.50" | 2.00" | .830" | 1.25" | M16 | - |